

WATERMELON PASTÈQUE

COLOUR GUIDE / DIAGRAMME EN COULEUR

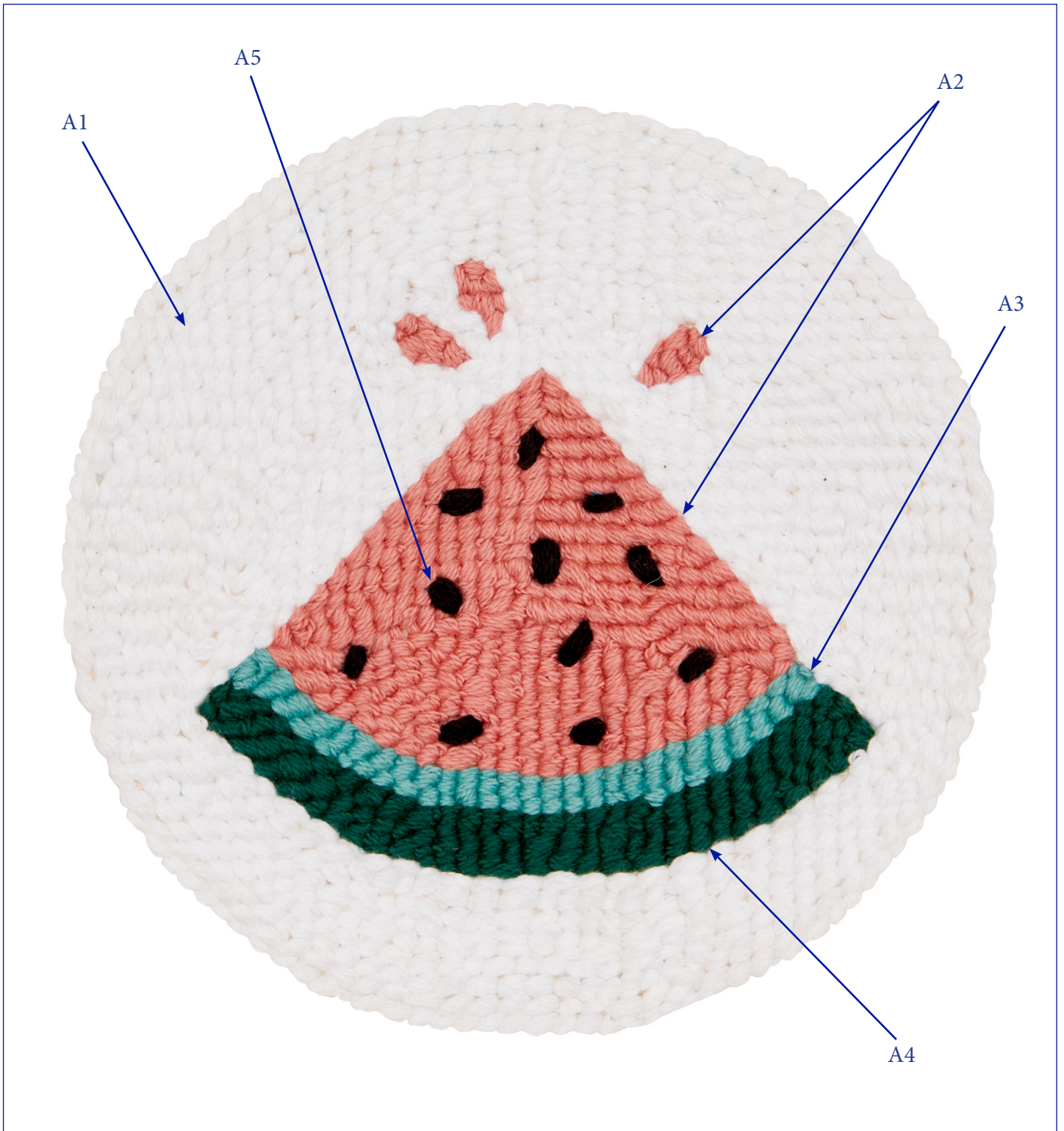

3D EMBROIDERY
BRODERIE 3D



CROCHET



CRAFTS
LOISIRS CRÉATIFS

WATERMELON

PASTÈQUE

TECHNICAL CHART / DIAGRAMME

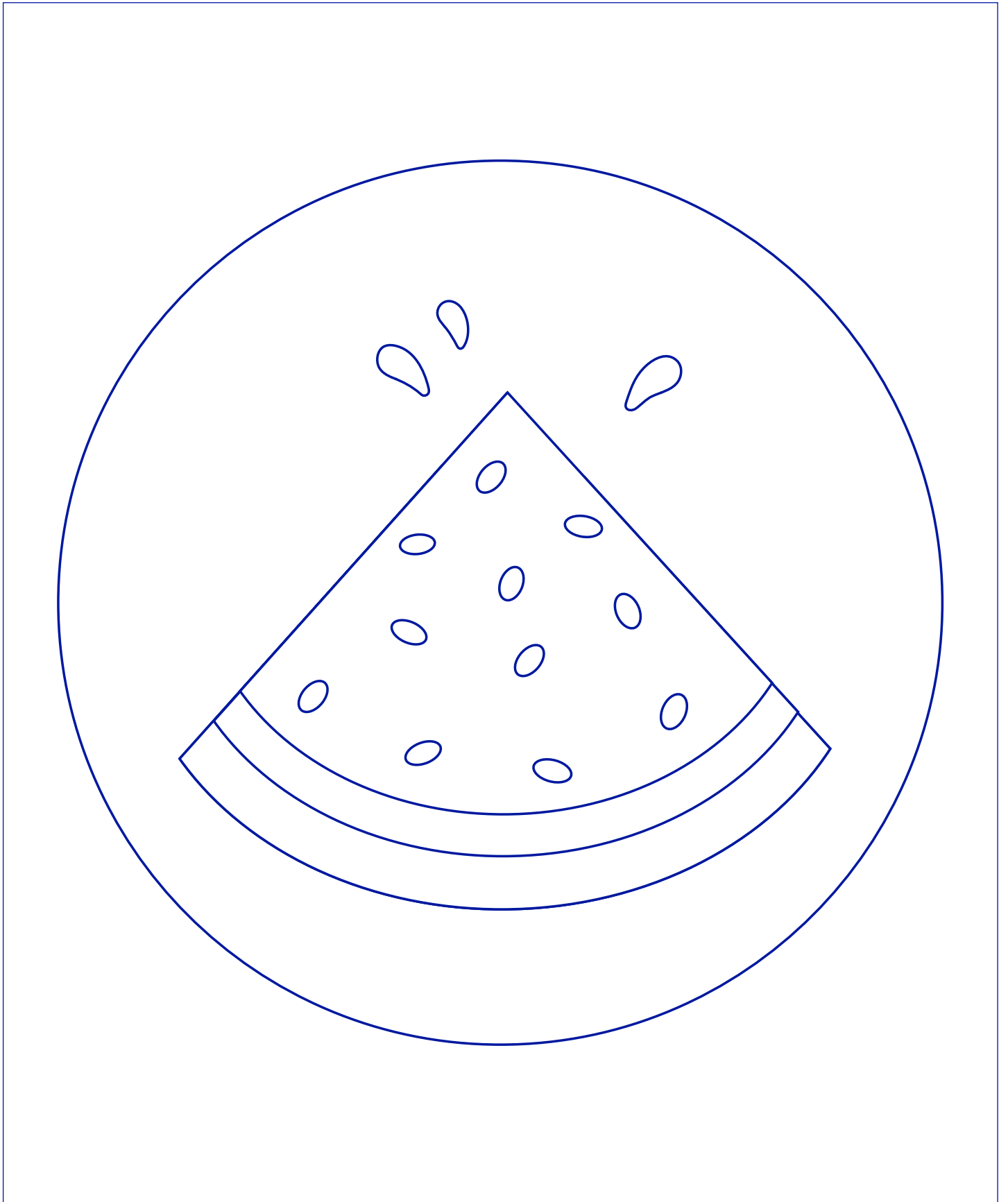

WWW.DMC.COM © 2021 / ALL RIGHTS RESERVED WORLDWIDE

DMC LIBRARY - BIBLIOTHÈQUE DMC

WATERMELON

PASTÈQUE

INSTRUCTIONS





TOOL KIT / FOURNITURES

DMC NATURA XL

PUNCHNEEDLE REGULAR IO

FABRIC AIDA 2.4PTS/CM, 6 CT / TOILE AIDA 2.4PTS/CM, 6 CT

COLOUR / COULEURS

| CODE N° CODE N° | COLOUR COULEUR | N° SKEINS* N° D'ÉCHEVETTES* | THREAD TYPE TYPE DE FIL |
|--------------------|--|--------------------------------|----------------------------|
| 1 |  01 | x 1 | Natura XL |
| 2 |  42 | x 1 | Natura XL |
| 3 |  07 | x 1 | Natura XL |
| 4 |  08 | x 1 | Natura XL |
| 5 |  02 | x 1 | Natura XL |

STITCHES / POINTS

CODE LETTER
LETTRE **A**

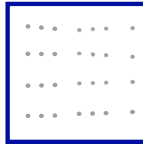

Smooth - Stitch on the front of the fabric /
Lisse: Travaillez sur l'endroit du tissu

USE | STRANDS
UTILISER | BRINS



*Number of strands and skeins calculated for design size 17cm x 17cm
Nombre de brins et d'échevettes calculé pour un dessin de 17cm x 17cm

INSTRUCTIONS

TECHNIQUES / TECHNIQUES

THE PUNCH NEEDLE / L'OUTIL

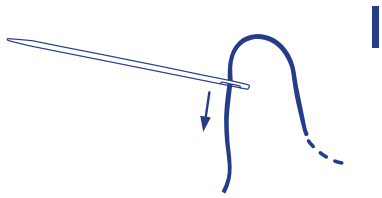

Thread the yarn into the wooden needle.
Enfiler le fil dans l'aiguille en bois.

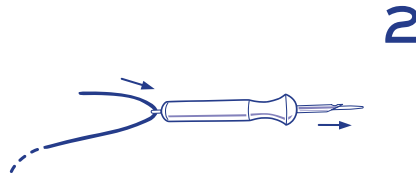

Insert the needle in the shaft.
Insérer l'aiguille dans le manche.

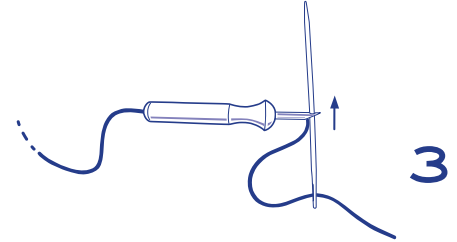

Pass the needle through the eye in the metal tip.
Passer l'aiguille à travers le chas de la pointe métallique.

Choose your pattern, take a piece of canvas and an embroidery hoop the appropriate size. Transfer the pattern onto the canvas and tighten it in the hoop. The charts tell you the yarns and colours you need.

Choisir le motif, prendre un morceau de toile et un tambour adaptés aux dimensions du motif. Reporter le motif sur la toile et la tendre dans le tambour. Chaque diagramme indique les fils et les couleurs nécessaires.

GETTING STARTED / COMMENCER

Hold the needle perpendicular to the canvas and punch through it so that the shaft touches the fabric.
Piquer l'outil

perpendiculairement dans la toile jusqu'au manche.

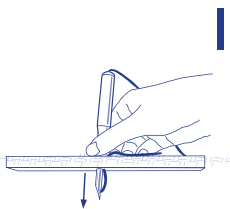

Gently pull the tip back out and move it slightly forward whilst staying in contact with the canvas.

Ressortir délicatement la pointe et la déplacer légèrement vers l'avant en restant en contact avec la toile.

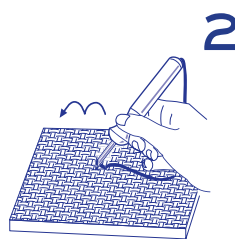

Repeat steps 1 and 2 continuing in the same direction.

Répéter les étapes 1 et 2 en allant toujours dans le même sens.

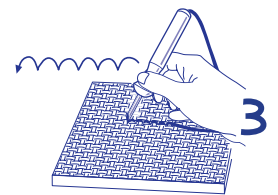

Des points plats se forment sur l'endroit et des boucles sur l'envers. Travailler alternativement sur l'endroit ou l'envers permet de varier les textures.

Flat stitches are formed on the working side and loops on the reverse side. Turning over the canvas and working from the other side allows you to vary the textures.

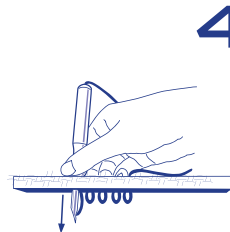

Tips: Do not pull on the yarn. To change direction, turn the needle so that you are still working in the same direction.

Conseils: Ne pas exercer de tension sur le fil. Pour changer de direction, tourner l'outil pour avancer toujours dans le même sens.